



# Fire-Resistant Steel Trap / Steel Door

## EI<sub>2</sub>30-C5-S<sub>a</sub> „Teckentrup 62“ 1lf. Outside door

Fire-resistant as outside door - classification with CE-labelling (acc. to EN 16034 / 14351-1)

### Text example:

EI<sub>2</sub>30-C5-S<sub>a</sub> classification fire-resistant closure as outside door with CE-labelling (acc. EN 16034 / 14351-1). Single leaf door element. Type of handling DIN right. Door leaf with thin rebate, 62 mm thick, rebated on 3 sides. Corner frame 1.5 mm thick with 3-sided seal, without floor recess. Door leaf and frame galvanized and prime coated similar to RAL 9002 (grey white). Mortise lock with latch lever in accordance with DIN 18250, prepared for profile cylinder. Black plastic round handle set. Handle pivoted on bearing, with tumbler insert (Bb) and 1 Bb key. 1 spring hinge and 1 CO hinge with ball bearings. „Teckentrup 62“ or equivalent.

(Compile and tender according to requirements. Please refer to technical data below for respective details. Updated 01.06.2023)

### Technical data

<b>Classification</b>	EI <sub>2</sub> 30-C5-S <sub>a</sub> classification fire-resistant closure as outside door with CE-labelling (acc. EN 16034 / 14351-1)		<b>Fittings</b>	<ul style="list-style-type: none"> <li>Mortise lock with latch lever prepared for profile cylinder</li> <li>FP-roound handle set, black (plastic), handle pivoted on bearing with tumbler insert.(Bb) and 1 Bb-key.</li> </ul>																														
<b>Resistance to water penetration</b>	Retractable bottom seal Class <b>5A</b> (thin rebate) opening outwards		<b>Glazing</b>	Fire resistant glass, clear F30 type 2-0, angular glazing with aluminium glass holding strips. Max. clear size 844 x 2090 mm. Round glazing (Ø 300, 400 und 500) with steel glass holding strips galvanized and prime-coated, grey-white similar to RAL 9002. Special equipment: <ul style="list-style-type: none"> <li>Rectangular glazing, aluminium glass holding strips in stainless steel design</li> <li>Rectangular/round glazing stainless steel glass holding strips</li> </ul>																														
<b>Heat insulation acc. EN ISO 10077-1</b> (without glazing)	Sheet thickness: 1,0 mm thin rebate 1,0 mm thick rebate in conjunction with lower floor closure / without glazing	U <sub>D</sub> = 1,3 W/m²K U <sub>D</sub> = 1,1 W/m²K	<b>Required for doors outside use:</b>	<ul style="list-style-type: none"> <li>Floor closure</li> <li>Rain guard top (necessary if no roof/canopy existing)</li> <li>Weather board at the bottom (recommended)</li> <li>Profile cylinder (recommended)</li> </ul>																														
<b>Wind load resistance EN 12210</b>	Depends on the desired floor closure thin rebate: thick rebate:	Class C3 - Class C5 Class C2	<b>Special equipment</b>	<ul style="list-style-type: none"> <li>Handle sets/lever/knob sets: - Plastic - Light metal - Stainless steel</li> <li>With short plate or rose escutcheon (various makes)</li> <li>Prepared for rose escutcheon</li> <li>Panic bar</li> <li>Locks - Anti-panic locks (self-locking) with lever   panic bar   panic push bar</li> <li>Profile cylinder 40.5 + 40.5 mm (thin rebate)</li> <li>Profile cylinder 45.5 + 35.5 mm (thick rebate)</li> <li>Top door closer - hinge/opposite hinge side - with slide rail -with hold-open device</li> <li>Electric door opener</li> <li>Lock control (bolt contact) integrated</li> <li>open indicator (reed contact) integrated</li> </ul>																														
<b>Air permeability</b>	Version: thin rebate retractable bottom seal With buffer strip and seal	Class 3 Class 4	<b>Standard sizes</b>	<table border="1"> <thead> <tr> <th>Standard sizes</th> <th>Ordering dimensions/ modular dimensions width x height</th> <th>Clear passage sizes (corner frame) width x height</th> </tr> </thead> <tbody> <tr> <td></td> <td>875 x 2000</td> <td>791 x 1958</td> </tr> <tr> <td></td> <td>2125</td> <td>2083</td> </tr> <tr> <td></td> <td>1000 x 2000</td> <td>916 x 1958</td> </tr> <tr> <td></td> <td>2125</td> <td>2083</td> </tr> <tr> <td></td> <td>1125 x 2000</td> <td>1041 x 1958</td> </tr> <tr> <td></td> <td>2125</td> <td>2083</td> </tr> <tr> <td></td> <td>1250 x 2000</td> <td>1166 x 1958</td> </tr> <tr> <td></td> <td>2125</td> <td>2083</td> </tr> <tr> <td></td> <td>2250</td> <td>2208</td> </tr> </tbody> </table>	Standard sizes	Ordering dimensions/ modular dimensions width x height	Clear passage sizes (corner frame) width x height		875 x 2000	791 x 1958		2125	2083		1000 x 2000	916 x 1958		2125	2083		1125 x 2000	1041 x 1958		2125	2083		1250 x 2000	1166 x 1958		2125	2083		2250	2208
Standard sizes	Ordering dimensions/ modular dimensions width x height	Clear passage sizes (corner frame) width x height																																
	875 x 2000	791 x 1958																																
	2125	2083																																
	1000 x 2000	916 x 1958																																
	2125	2083																																
	1125 x 2000	1041 x 1958																																
	2125	2083																																
	1250 x 2000	1166 x 1958																																
	2125	2083																																
	2250	2208																																
<b>Differential climate behaviour</b>	climate class	2(d) / 2(e)	<b>Installation in</b>	<ul style="list-style-type: none"> <li>Masonry wall min. 115 mm</li> <li>Concrete wall min. 100 mm</li> <li>Aerated concrete - Autoclaved aerated concrete min. 115 mm - Reinforced AAC walls min. 115 mm</li> </ul>																														
<b>Approved dimensions</b> all other sizes require technical clarification	MD - <b>thin rebate:</b> with top light/ top casing up to	W 500 - 1500 mm H 500 - 4000 mm H 4250 mm	<b>Type of handling</b>	DIN right or DIN left																														
	MD - <b>thick rebate:</b> with top light/ top casing up to	W 500 - 1500 mm H 500 - 3500 mm H 3750 mm	<b>Door leaf</b> (double skinned)	Rebate type <b>thin-, thick rebate</b> Trap: 4-sided rebated Door : 3-sided rebated Door leaf thickness: 62 mm Sheet thickness: 1.0 mm Security bolt: min. - / 1																														
<b>Frame</b>	<ul style="list-style-type: none"> <li>Corner frame 1.5/2.0 mm, trap door 4-sided</li> <li>Door 3-sided with seal</li> <li>Door without floor recess fitted</li> <li>Fastening by exposed masonry mounting</li> </ul> Special equipment: <ul style="list-style-type: none"> <li>Block-, counter- or closed frame</li> <li>Frame with floor recess fitted</li> </ul>		<b>Floor closure</b>	<ul style="list-style-type: none"> <li>Retractable bottom seal</li> <li>Sliding threshold</li> <li>Buffer strip and seal</li> <li>Floor seal retrofittable.</li> </ul>																														
<b>Surface</b>	Door leaf/Frame galvanized and prime coated, similar to RAL 9002 (Grey white). Special equipment: RAL of choice		<b>Hinges and closing devices</b>	<ul style="list-style-type: none"> <li>1 spring hinge and 1 CO hinge or</li> <li>2 CO hinges and 1 top door closer</li> </ul>																														

(Special sizes: from 500 x 1750 mm to 1500 x 4000 mm)

**Further qualifications**  
(Special equipment):



**Smoke proof** in accordance with EN 1634-3 with top door closer, for solid walls



**Sound insulated** in accordance with EN 20140/717-1  
 up to **RW 42 dB** (thin rebate)  
 up to **RW 42 dB** (thick rebate)  
 depending on door structure and bottom seal



**Burglar resistant**  
 in acc.with EN 1627 -  
**RC 2, RC 3, RC 4** (thin rebate)  
**RC 2, RC 3** (thick rebate)

**Fire-Resistant Steel Trap / Steel Door**  
**EI<sub>2</sub>30-C5-S<sub>a</sub> „Teckentrup 62“ 1lf. Outside door**

Fire-resistant as outside door - classification with CE-labelling (acc. to EN 16034 / 14351-1)

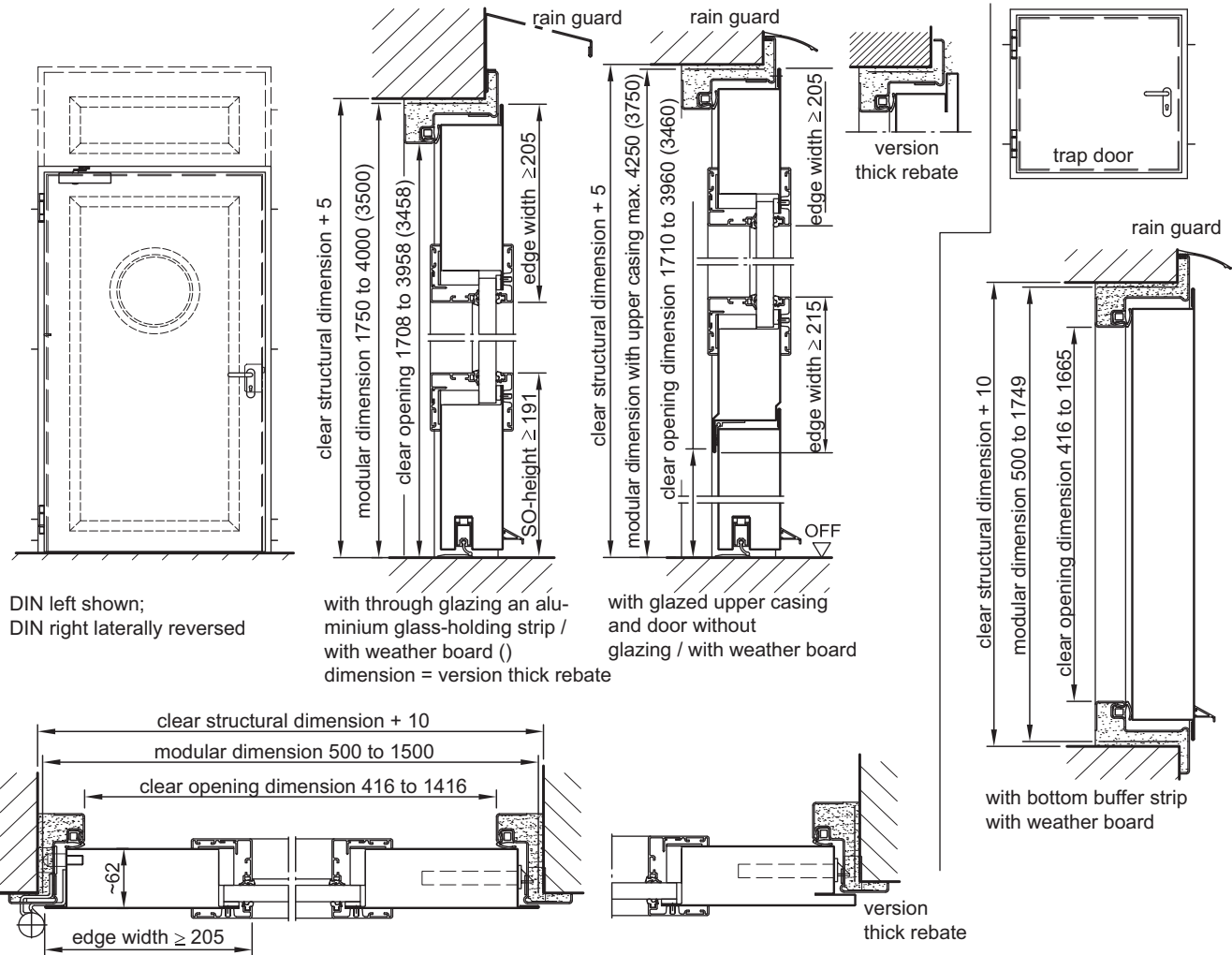

**Floor connections:**

- Image 1: with bottom buffer
- Image 2: with bottom buffer/seal
- Image 3: with retractable bottom seal (smoke-proof door with top door closer)
- Image 4: with sliding threshold seal

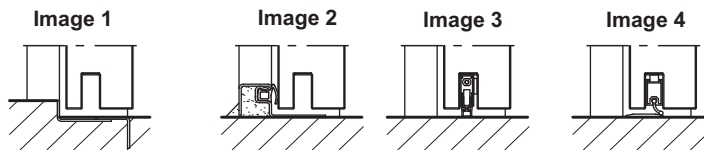

**Installation in masonry/ concrete walls**

concrete walls  $\geq 100$  mm  
masonry walls  $\geq 115$  mm

**exposed masonry mounting**

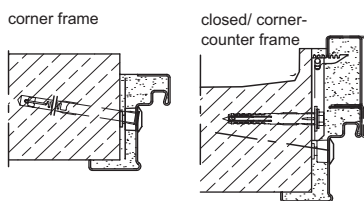

**flush edge installation**

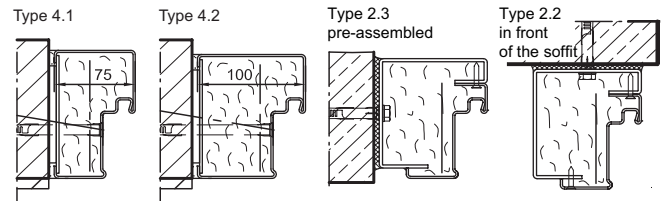

**Installation in autoclaved aerated concrete walls (doors with top door closer)**

Made of auto. aerated concrete blocks or reinforced auto. aerated concrete thickness min. 115 mm

**exposed masonry mounting**

