



Fire proof steel door EI₂90-C5-S_a „Teckentrup 62“ 2lvs. outside door

Fire-resistant closure as outside door -Classification with CE labelling (acc. EN 16034 / 14351-1)

Text example:

EI₂90-C5-S_a, Classification fire-resistant closure as outside door with CE-labelling (acc. EN 16034 / 14351-1). Double leaf door element. Type of handling DIN right. Flush edged door leaf with thin rebate, 62 mm thick, 3-sided rebated. Corner frame 1.5 mm thick with 3-sided seal, without floor recess. Door leaf and frame galvanised and prime coated, grey white similar RAL 9002. Active leaf mortise lock with latch function PC perforated acc. DIN 18250. FP-round handle set, black (plastic). Handle pivoted on bearing with tumbler insert and 1 Bb-key. Inactive leaf with espagnolette lock with standard top locking. 2 construction hinges with ball bearing and 1 top door selector acc. EN 1154.1 door selector. „Teckentrup 62“ or equivalent. (Compile and tender according to requirements. Please refer to technical data below for respective details. Updated Stand 01.05.2023)

Technchal data

Classification	EI ₂ 90-C5-S _a Classification fire-resistant closure as outside door with CE-labelling (acc. EN 16034 / 14351-1)	
Installtion in	Masonry	min. 175 mm
	▪ Concrete	min. 140 mm
	▪ Autoclaved aerated concrete	
	- for stones	min. 175 mm
	- for reinforced type	min. 175 mm
Approved dimensions all other sizes require technical clarification	Modular-dim. thin rebate:	W 1375 - 2500 mm H 1750 - 2500 mm
	with upper casing/top light	H 3500 mm
	Modular dim. thick rebate:	W 1375 - 2500 mm H 1750 - 2500 mm
Type of handling	DIN right or DIN left	
Door leaf double skinned	Rebate type:	thin-. thick rebate
	Door:	3-sided rebated
	Door leaf thickness:	62 mm
	Sheet thickness:	1.0 mm or 1.5 mm
	Security bolt:	per leaf min. 3
Frame	<ul style="list-style-type: none"> ▪ Corner frame 1.5/2.0 mm thick ▪ Door 3-sided with seal ▪ Door without floor recess ▪ Fastening by exposed masonry mounting Special equipment: <ul style="list-style-type: none"> ▪ Block-, counter-, or closed frame ▪ Frame with floor recess 	
Heat insulation	Thermal transmittance acc. EN ISO 12567-1 (without glazing) (thin.- / thick rebate) Sheet thickness 1.0 mm: $U_D = 1.7 / 1.8 \text{ W/m}^2\text{K}$ Sheet thickness 1.5 mm: $U_D = 1.5 / 1.6 \text{ W/m}^2\text{K}$ in conjunction with bottom floor closure	
Floor closures	<ul style="list-style-type: none"> ▪ Retractable bottome seal ▪ Sliding threshold ▪ Buffer strip with seal Retrofittable bottom seal.	
Surface	Door leaf/Frame galvanised and prime coated, grey white similar RAL 9002 Special equipment: <ul style="list-style-type: none"> ▪ RAL of choice 	
Fittings	Active leaf: <ul style="list-style-type: none"> ▪ Mortise lock with latch function PC perforated ▪ FP round handle set, black (plastic). Handle pivoted on bearing, with tumler insert and 1 Bb-key Inactive leaf: <ul style="list-style-type: none"> ▪ Espagnolette bolt lock with standard top and bottom locking 	
Hinges and closing devices	<ul style="list-style-type: none"> ▪ per leaf 2 CO hinges with ball bearing and ▪ 2 top door closer ▪ 1 door selector 	

Glazing	Fire-resistant glass clear F90 type 2-0, rectangular glazing with aluminium glass holding panes. Max. clear size 940 x 2203 mm. Round glazing (Ø 300, 400 and 500) with steel glass holding strips galvanised and prime coated, grey white similar RAL 9002. Special equipment: <ul style="list-style-type: none"> ▪ Rectangular glazing-aluminium glass holding strip in stainless steel design ▪ Rectangular-/roeund glazing glass holding strips mad of stainless steell
----------------	--

Required for doors for outside use:	<ul style="list-style-type: none"> ▪ Bottom closure ▪ Top rain guard (necessary if no roof/canopy-existing) ▪ Weather board at the bottom (recommendation) ▪ Profile cylinder (recommendation)
--	--

Special equip-ment	<ul style="list-style-type: none"> ▪ Handle sets / Lever/Knob sets: <ul style="list-style-type: none"> - Plastic - Light metal - Stainless steel - with short plate or rose escutcheon (various makes) ▪ prepared for rose escutcheon ▪ Panic-/bar handle ▪ Locks <ul style="list-style-type: none"> - Antipanic locks (self locking) with lever rod handle push bar ▪ Profile cylinder 40.5 + 40.5 mm (thin rebate) ▪ Profile cylinder 45.5 + 35.5 mm (thick rebate) ▪ Top door closer <ul style="list-style-type: none"> - hinge-/opposite hinge side - with slide rail - with hold-open device ▪ Electrical door opener ▪ Integrated lock inspector (bolt contact) ▪ Integrated opening indicator (reed contact)
---------------------------	---

Standard sizes	Ordering dim./ modular dimension width x height	Clear passage sizes (corner frame) width x height
	1500 x 2000	1416 x 1958
		2125 2083
	1750 x 2000	1666 x 1958
		2125 2083
	2000 x 2000	1916 x 1958
		2125 2083
		2500 2458
	2125 x 2125	2041 x 2083
	2250 x 2250	2166 x 2208
	2500 x 2500	2416 x 2458

(Special sizes: from 1375 x 1750 mm to 2500 x 2500 mm)

Furhter qualifications
(Special version):



Smoke proof acc. EN 1634-3 with TDC. for solid walls



Sound insulated acc. EN 20140/717 part 1 up to **RW 42 dB** (thin rebate) up to **RW 42 dB** (thick rebate) depending on door construction and equipment of the bottom seal.



Burglar resistant acc. EN 1627 - **RC 2, RC 3, RC 4** (thin rebate) **RC 2, RC 3** (thick rebate)



Fire-proof steel door EI₂90-C5-S_a „Teckentrup 62“ 2lvs. outside door

Fire-resistant closure as outside door -Classification with CE labelling (acc. EN 16034 / 14351-1)

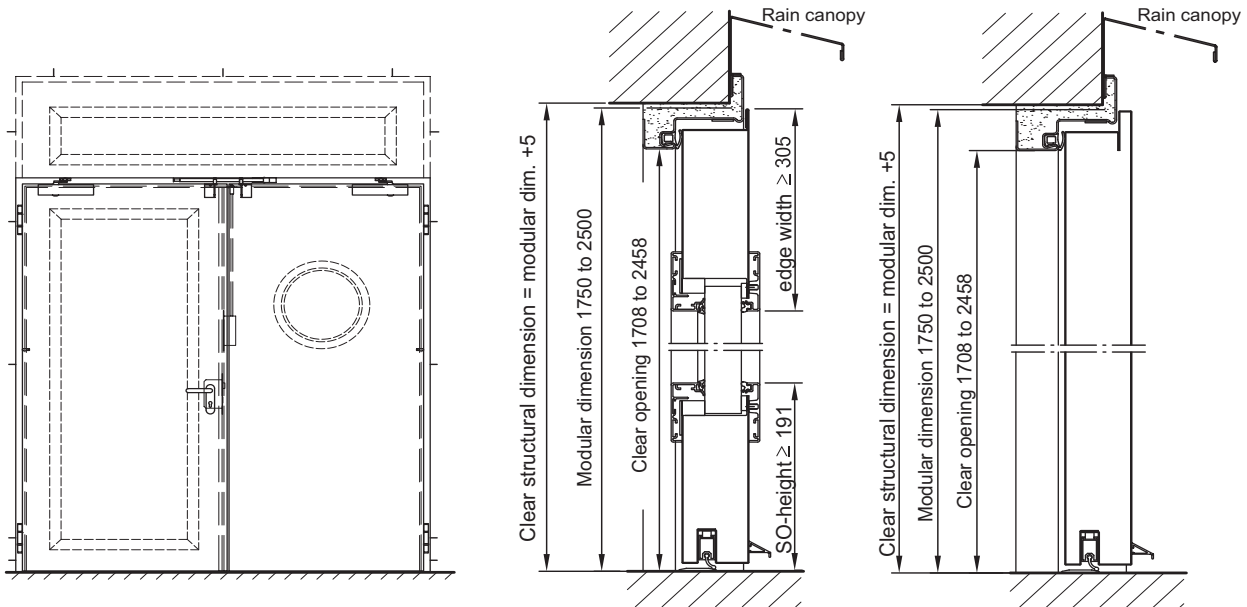

DIN left shown;
DIN right laterally reversed

Version rebate type
thin rebate with glazing
and aluminium glass
holding strips

Version rebate type
thick rebate

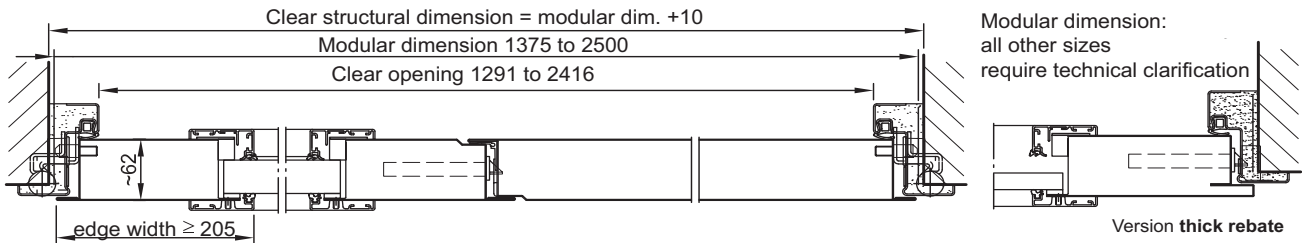

Floor connections:

- Image 1: with bottom buffer
- Image 2: with bottom buffer/seal
- Image 3: with retractable bottom seal (Smoke proof door with TDC)
- Image 4: with sliding threshold seal

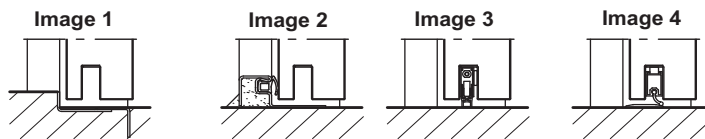

**Installation in masonry/
concrete walls**
concrete walls ≥ 140 mm
masonry walls ≥ 175 mm

Exposed masonry mounting

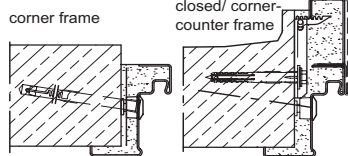

Flush edge installation

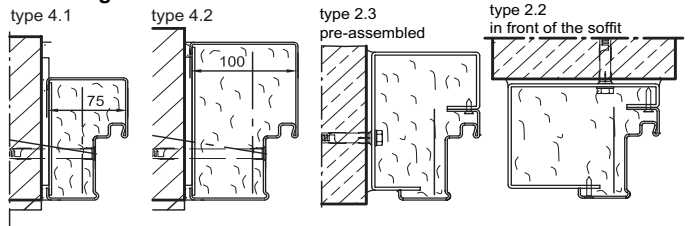

**Installation in autoclaved
aerated concrete walls**
(doors with TDC)
Made of auto. aerated
concrete stones
or reinforced auto. aerated
concrete, wall thickness
min. 175 mm

Exposed masonry mounting

