



## Steel door dw 62-1 „Teckentrup DF“ iso+

Heat insulation  $U_D = 0.83 \text{ W}/(\text{m}^2 \cdot \text{K})$

### Text example:

dw 62-1 steel door. Single-leaf door element

Type of handing DIN right. Door leaf 62 mm thick, thick rebated on 3-sides. Corner frame 1.5 mm thick, galvanized 3-sided seal and bottom sill. Door leaf and frame galvanized, and prime coated Grey white similar to RAL 9002. Hinge and opposite hinge side thermally separated. Mortice lock prepared for profile. Round handle set, black (plastic), pivoted on bearing with tumbler, 1 Bb key. 3-D hinges.

1 security bolt. "Teckentrup" or equivalent.

(Compile and tender according to requirements. Please refer to technical data below for respective details. Updated 1. April 2018)

### Technical data

<b>Product</b>	<b>dw 62-1-Tür „Teckentrup DF“ iso+</b> Heat transfer coefficient in accordance to EN ISO 12567-1: $U_D = 0.83 \text{ W}/(\text{m}^2 \cdot \text{K})$	<b>Special equipment</b>	<ul style="list-style-type: none"> <li>▪ Handle sets / Lever/Knob sets::</li> <li>▪ plastic</li> <li>▪ light metal</li> <li>▪ stainless steel</li> <li>▪ with short plate or rose escutcheon (various makes)</li> <li>▪ Prepared for rose escutcheon</li> <li>▪ Triple locking system</li> <li>▪ Locks               <ul style="list-style-type: none"> <li>- profile cylinder 45,5 + 35,5 mm</li> <li>- panic locks</li> </ul> </li> <li>▪ Top door closer DIN EN 1154</li> <li>▪ with bottom buffer/seal</li> <li>▪ Aluminium rain guard</li> </ul>
<b>Installation in</b>	<ul style="list-style-type: none"> <li>▪ Masonry</li> <li>▪ Concrete</li> <li>▪ Autoclaved aerated concrete</li> <li>▪ Lightweight construction wall</li> </ul>		
<b>Dimensions</b>	Width: 625 - 1250 mm Height: 1750 - 2350 mm		
<b>Type of handing</b>	DIN right or DIN left		
<b>Door leaf</b>	Double-skinned, thin rebated on 3 sides, <b>thick rebate</b> Hinge and opposite hinge side thermally separated. Leaf thickness: 62 mm Sheet thickness: 0.75/1.0 mm Security bolt: min. 1 Reinforcement: Flat steel Insulation: PU foam core Seal: retractable bottom seal		
<b>Frame</b>	Corner frame 1.5 mm thick, galvanized 3-sided seal and bottom sill. Frame fixed with 3 screws each side Thermally separated Special equipment: with closed frame		
<b>Surface</b>	Door leaf and frame galvanized and prime coated Grey white similar to RAL 9002. RAL colour optional		
<b>Hinges</b>	<ul style="list-style-type: none"> <li>▪ 3-D hinges, galvanized</li> </ul>		
<b>Fittings</b>	<ul style="list-style-type: none"> <li>▪ Mortice lock with latch lever, prepared for profile cylinder</li> <li>▪ Round handle set, black (plastic) with short plate, handle pivoted on bearing with tumbler, 1 Bb key</li> </ul>		

#### Further qualifications (special equipment)



Sound insulated, tested in accordance with DIN EN 20140/717-1  
Sheet thickness 1.0 mm.  
Insulation: mineral wool, incl. retractable bottom  
 $U_D = 1.0 \text{ W}/(\text{m}^2 \cdot \text{K})$  Rw **38 dB**



Burglar-resistant door in accordance with DIN ENV 1627 - RC 2 (WK 2)  
Sheet thickness 1.0 mm.  
Insulation: mineral wool, incl. retractable bottom  
 $U_D = 1.0 \text{ W}/(\text{m}^2 \cdot \text{K})$  Rw **38 dB**

**Steel door dw 62-1**  
**„Teckentrup DF“ iso+**

Heat insulation  $U_D = 0.83 \text{ W}/(\text{m}^2 \cdot \text{K})$

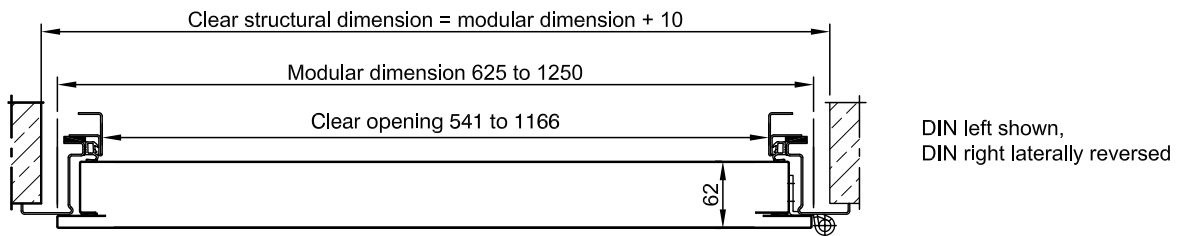
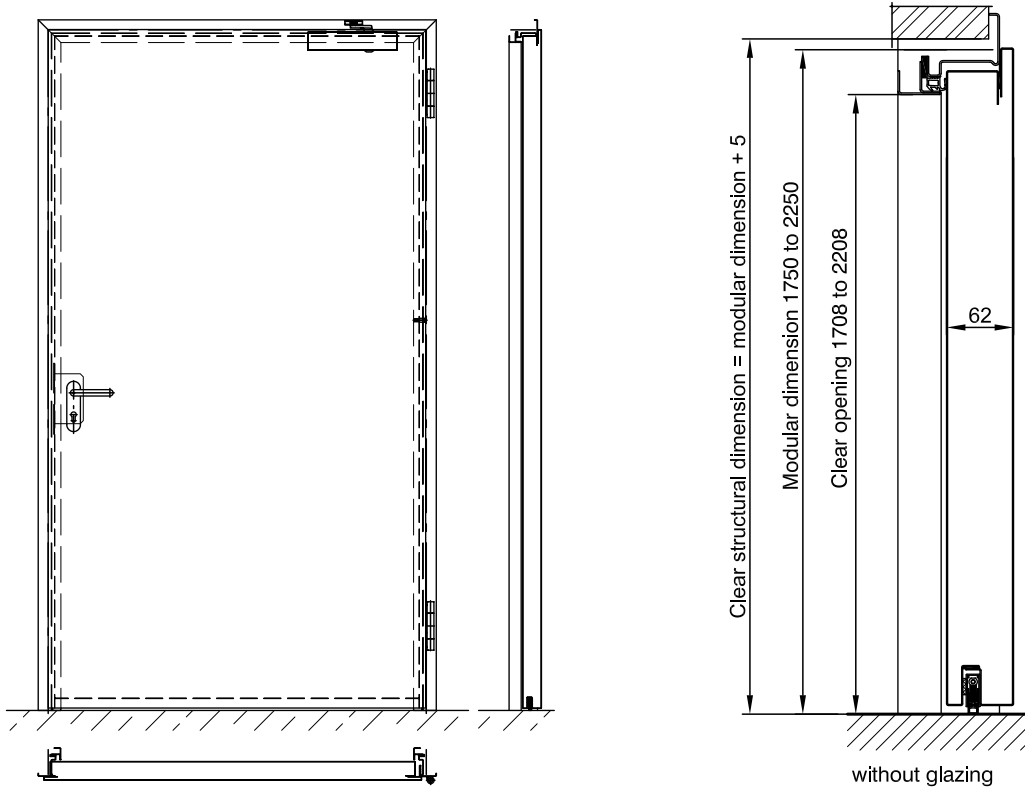

**Floor connections:**

- Image 1: With bottom buffer
- Image 2: With bottom buffer/seal
- Image 3: With bottom seal

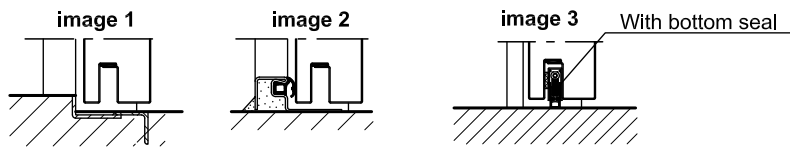

**Installation in masonry/  
concrete walls**

**exposed masonry mounting**

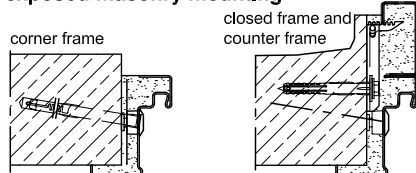

**Installation in autoclaved  
aerated concrete walls**

**exposed masonry mounting**

