

Bullet-proof steel door dw 64-1

„Teckentrup BP“ Class FB4

(corresponds to Class M3 in accordance with German performance requirements)

Available with optional glazing in accordance with DIN EN 1063 - BR 4 (NS = shatter proof on the inside)

Text example

Compile and tender according to requirements.

Please refer to technical data below for respective details.

Updated 1st June 2015



Position	No. of pieces	Item	Unit price €	Total price €
		dw 64-1 „Teckentrup BP“ FB4 bullet-proof single leaf steel door, double-skinned. Type of handing DIN right. Door leaf and frame galvanized and prime coated similar to RAL 9002 (Grey white), 64 mm thick, rebated on 3-sides. 2.0 mm thick corner frame with 3-sided seal and bottom sill. Mortice lock prepared for profile cylinder . 1 security bolt, 2 two-part KO hinges with ball bearings.		
		„Teckentrup“ or equivalent.		

Technical data

Product:	Bullet-proof steel door dw 64-1 „Teckentrup BP“ FB4 Tested in accordance with DIN EN 1522 Class FB4		
Installation in:	<ul style="list-style-type: none"> Masonry min. 240 mm Concrete min. 140 mm 		
Dimensions:	Width: 750 - 1500 mm Height: 1750 - 3000 mm		
Type of handing:	DIN right or DIN left		
Door leaf:	Double-skinned, thick rebated on 3 sides Filling: steel plate mineral wool gypsum board Door leaf thickness: 64 mm Sheet thickness: 1.5 mm Security bolt: 1		
Frame:	2.0 mm thick corner frame with 3-sided seal and bottom sill. Frame fixed with screws, 3 screws each side. Special equipment: block frame, counter frame or closed frame		
Surface:	Galvanized and prime-coated door leaf and frame (Grey white), similar to RAL 9002.		
Hinges:	<ul style="list-style-type: none"> 2 two-part KO hinges with ball bearings, secured hinge bolts. 		
Fittings:	<ul style="list-style-type: none"> Mortice lock with latch lever, prepared for profile cylinder. Plastic handle set black. Handle pivoted on bearing with tumbler insert (Bb) and 1 Bb key. 		

Glazing: In accordance with DIN EN 1063 BR 4, glass thickness 49 mm with steel holding strips, NS shatter proof on the inside

Special equipment:

- Handle sets / Lever/Knob sets: (various makes) with fixed outer knob
- Locks
 - Profile cylinder 40.5 + 40.5 mm
 - Panic locks
- Floor seals
- Rectangular glazing (special size)
- Aluminum rain guard

Further qualifications (special equipment):



• **Fire resistant** tested as per EN 1342-1 (DIN 4102)



• **Sound insulated** as per DIN EN 20140/717-1 up to **Rw 45 dB**



• **Burglar-resistant** as per DIN EN 1627 - **RC 4**

Bullet-proof steel door dw 64-1

„Teckentrup BP“ Class FB4

TECKENTRUP
DOOR SOLUTIONS

(corresponds to Class M3 in accordance with German performance requirements)

Available with optional glazing in accordance with DIN EN 1063 - BR 4 (NS = shatter proof on the inside)

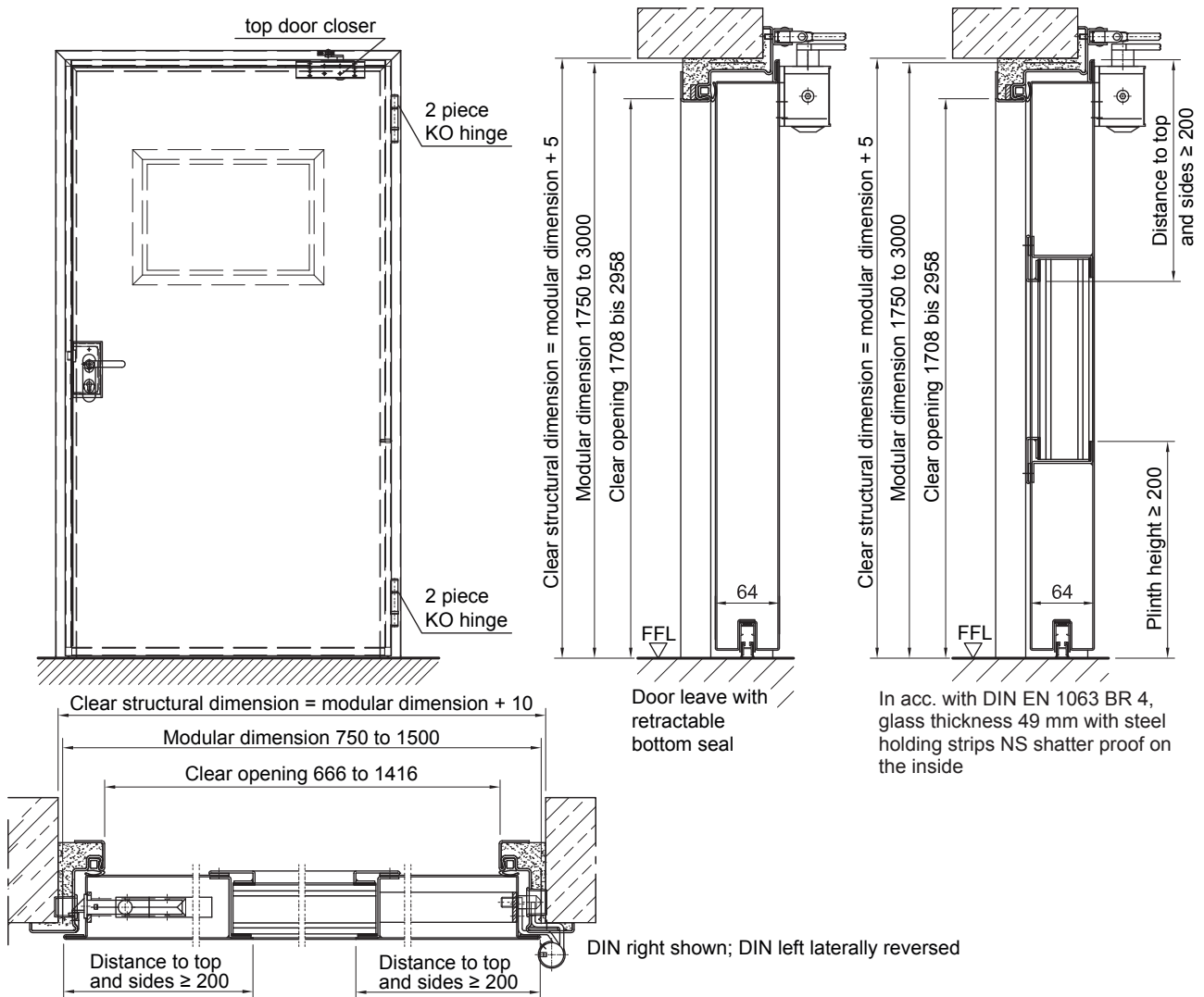

Floor connections:

Image 1: with bottom buffer

Image 2: with bottom buffer/seal

Image 3: with bottom seal

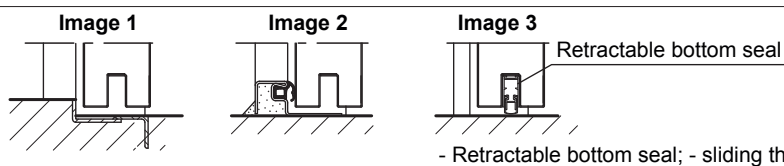

Installation in masonry/ concrete walls

concrete walls ≥ 140 mm
masonry walls ≥ 240 mm

Wall plug assembly

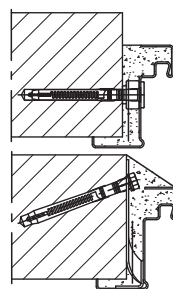
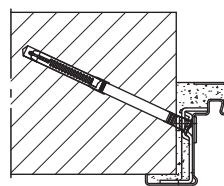

Wall plug assembly - closed frame and counter frame

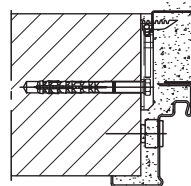

Anchor assembly

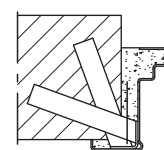

Weld-on assembly

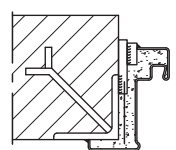

Installation in masonry/ concrete walls

flush installation between
concrete walls ≥ 140 mm
masonry walls ≥ 240 mm

