



Prison cell door „Teckentrup“

Type A with static loading acc. RC 3 tested
Type B + T15 with static loading acc. RC 4 tested and
15-minute opening and unlocking process when exposed to fire

Type B with static loading acc. RC 4 tested

Text example:

Prison cell door "Teckentrup". Single leaf door element. Type of handling DIN right. Door leaf 64 mm thick with thin rebate, 3-sided rebated without bottom buffer. Corner frame galvanised 2.0 mm thick, with impact absorbing buffer in the frame, without floor recess. Door leaf and galvanised frame and prime coated, grey white similar RAL 9002. Prepared for prison cell door lock. 2 three-piece special hinges with ball bearing.

„Teckentrup“ or equivalent.

(Compile and tender according to requirements. Please refer to technical data below for respective details. Updated 01.03.2021)

Technical data

Product	Prison cell door „Teckentrup“ Tested acc. with the PTE Rosenheim GmbH regulations in collaboration with the VFS Verband für Sicherheitstechnik e.V. (association for security engineering) and its members, the responsible ministries of justice, the state building authorities, construction and properties offices and penal institutions as well as the manufacturers
Installation in	▪ Masonry (≥ 115 mm) and concrete (≥ 120 mm)
Dimensions	Width: 750 – (1250) 1500 mm Height: 1750 – (2250) 2500 mm () Type B + T15
Type of handling	DIN right or DIN left
Door leaf	Double skinned -„Anti-noise coating“ thin rebate rebate width min. 20 mm, - 3-sided rebated without bottom buffer, - or 4-sided rebated with bottom buffer, Door leaf thickness: 64 mm Sheet thickness: 1.5 mm / 2.0 mm (cell side) Security bolt: min. 2 Special equipment: ▪ sheet thickness 2.0 mm (corridor side)
Frame	Corner frame 2.0 mm thick, with impact absorbing buffer, prepared for 3-sided EPDM frame all-round seal. Frame seal, without floor recess. Standard frame attachment using masonry anchor Special equipment: ▪ Corner frame 3.0 mm thick with impact absorbing damper prepared for 3-sided EPDM frame all-round seal ▪ Closed frame 3.0 mm thick without frame seal ▪ Counter frame 3.0 mm thick ▪ Block frame, optionally with frame seal
Surface	Door leaf/frame galvanised and prime coated, grey white similar RAL 9002 Special equipment: ▪ RAL of choice
Fittings	▪ 2 pieces special hinges, galvanised, with ball bearing and hinge protection ▪ prepared for prison cell door lock provided by the customer (bolt- and/or latch lock). Brands: STUV, KABA, Technolog, Schlechtendahl etc. ▪ Special lock case for lock provided by the customer incl. cut out for inserted face plate ▪ Prepared for escutcheons / plates to match locks provided by the customer. ▪ With aluminium door knob on oval escutcheon.

Also available in **STAINLESS STEEL!**

Special equipment door leaf	<ul style="list-style-type: none"> ▪ Stainless steel chain guard (door protector made of stainless steel required on one side) ▪ Stainless steel door protector (one side/both sides) ▪ Additional security bolt ▪ Retractable bottom seal ▪ Sliding threshold seal ▪ * Food hatch (flush-mounted) <ul style="list-style-type: none"> - ca. 270 x 182 (B x H) clear window hatch (opening angle 90° or. 170°) with latch lock or prepared for prison cell door lock - Stainless steel ledge on the inside (90° opening angle) - Food hatch with special size (without test certificate at > 450 cm²) ▪ * Window <ul style="list-style-type: none"> - Window for clear view 270 x 167 mm, class P6B glazing - Window cover as single-skinned metal plate with revolving door function, piano hinge with magnetic locking - Special-sized window (without test certificate at > 450 cm²) ▪ Shackle hatch with revolving door function (170° opening angle) <p>* According to the PTE Rosenheim regulations, not larger than 450 cm² (Iclear window hatch/section) with a maximum length of 350 mm based on the sight opening</p>
Additional equipment fittings	<ul style="list-style-type: none"> ▪ Stainless steel bow-type handle (length 500 mm) ▪ Wide angle spyhole with opening/closing cover, standard height: 1550 mm ▪ Rotating spyhole (wide angle / tablet hatch / closed) ▪ Special spyhole on request ▪ Additional bolt lock up and/or down ▪ Inner sliding bolt made of flat steel 30x10 mm, with steel actuating handle (not available in combination with espagnolette bolt lock) ▪ Prepared for prison cell door lock with espagnolette bolt lock ▪ Prepared for prison cell door lock with electrical control (cable access point) ▪ Top door closer ▪ 3rd central door hinge ▪ Door stop ▪ Stainless steel door knob on round escutcheon ▪ Prison cell door locks
Additional electrical equipment	<ul style="list-style-type: none"> ▪ Prepared for bolt contact/magnetic contact ▪ Installation of bolt contacts/magnetic contacts



Prison cell door „Teckentrup“

Type A with static loading acc. RC 3 tested

Type B with static loading acc. RC 4 tested

Type B + T15 with static loading acc. RC 4 tested and

15-minute opening and unlocking process when exposed to fire

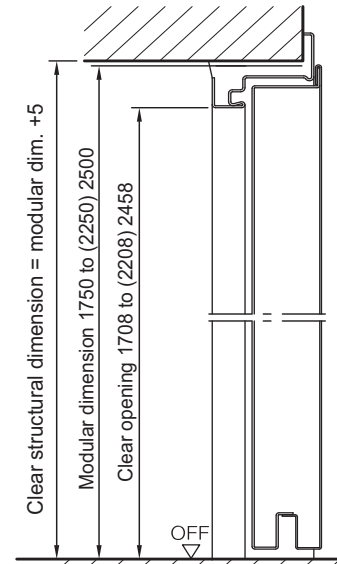
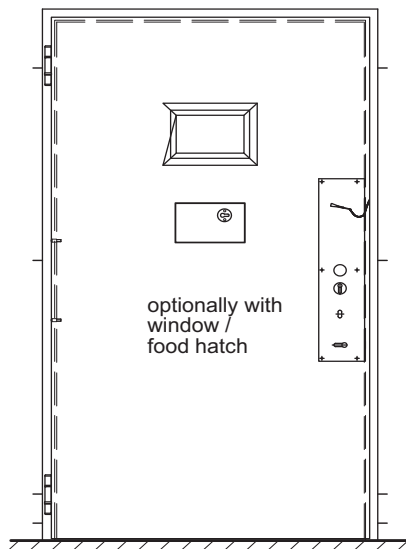

Door leaf - 3-sided rebated, without bottom buffer, without floor recess

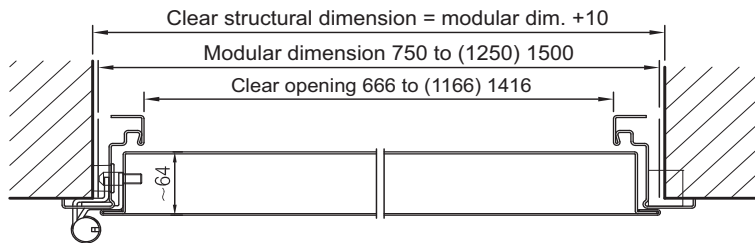

Active leaf DIN left shown; DIN right laterally reversed () = type b + T15

Floor connections:

- Image 1: with bottom buffer door leaf 4-sided rebated
- Image 2: without bottom buffer with floor recess door leaf 3-sided rebated

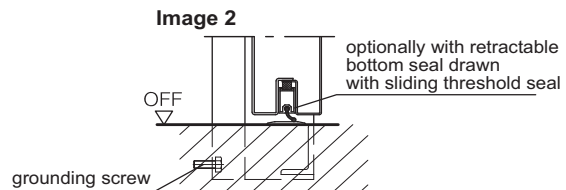
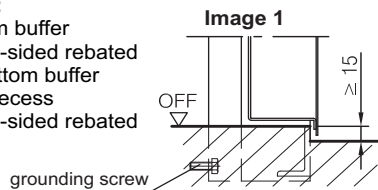

Installation in masonry/ concrete walls
(mortar backfilling)

Masonry anchor plugged

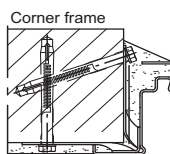

elbetonlert

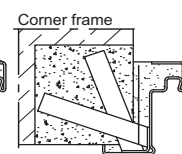

Exposed masonry mounting

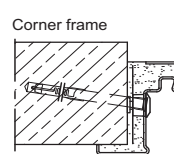

Closed-/ corner-counter frame

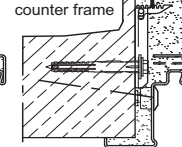

Flush edge installation

Type 2.3 pre-assembled

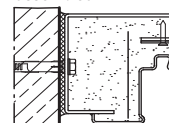

Type 2.2 in front of the soffit

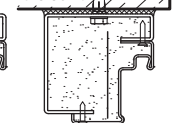

Please find a detailed installation overview in the planning-, installation- and maintenance manual for 1-leaf and 2-leaf doors.